



Please log on to:
www.tullamorecourthousehotel.ie/3d-floor-plans
 for a detailed overview of each of our suites.

Dimensions and capacities

This table contains the dimensions and capacities of all our conference suites and will help you to choose the suite which best suits your event requirements.

Conference Suites	L x W (m)	Area (m ²)	Ceiling Height (m)	Theatre	Classroom	U-Shape	Boardroom	Cabaret x 6	Cabaret x 8	Banqueting
DE Williams Suite	33 x 16	528	4.39, lowest point 4.11	750 persons	350 persons	-	-	180 persons	240 persons	550 persons
DE Williams Suite I	16 x 9.3	148.8	4.39, lowest point 4.11	160 persons	70 persons	40 persons	45 persons	54 persons	72 persons	100 persons
DE Williams Suite II	16 x 9.4	150.4	4.39, lowest point 4.11	160 persons	70 persons	40 persons	45 persons	54 persons	72 persons	100 persons
DE Williams Suite III	16 x 14	224	4.39, lowest point 4.11	270 persons	120 persons	60 persons	65 persons	72 persons	96 persons	150 persons
DE Williams Suite I & II	18.7 x 16	299.2	4.39, lowest point 4.11	370 persons	140 persons	-	-	108 persons	144 persons	220 persons
DE Williams Suite II & III	23.4 x 16	374.4	4.39, lowest point 4.11	550 persons	240 persons	-	-	126 persons	168 persons	250 persons
P & H Egan Suite	10 x 9	90	2.9	85 persons	45 persons	30 persons	40 persons	30 persons	40 persons	-
P & H Egan Suite I	9 x 4.7	42.3	2.9	40 persons	20 persons	16 persons	18 persons	12 persons	16 persons	-
P & H Egan Suite II	9 x 5.3	47.7	2.9	45 persons	24 persons	18 persons	20 persons	18 persons	24 persons	-
Conference Centre										
Manly Suite	9.5 x 9.3	88.3	2.8	80 persons	40 persons	25 persons	35 persons	30 persons	40 persons	-
Manly Suite I	9.5 x 4.6	43.7	2.8	35 persons	16 persons	14 persons	16 persons	12 persons	16 persons	-
Manly Suite II	9.5 x 4.7	44.6	2.8	35 persons	16 persons	14 persons	16 persons	12 persons	16 persons	-
Goodbody Suite	17.3 x 9.5	164.3	2.8	160 persons	70 persons	40 persons	60 persons	54 persons	72 persons	100 persons
Goodbody Suite I	9.5 x 4.33	41.1	2.8	35 persons	16 persons	14 persons	16 persons	12 persons	16 persons	-
Goodbody Suite II	9.5 x 4.33	41.1	2.8	35 persons	16 persons	14 persons	16 persons	12 persons	16 persons	-
Goodbody Suite III	9.5 x 4.33	41.1	2.8	35 persons	16 persons	14 persons	16 persons	12 persons	16 persons	-
Goodbody Suite IV	9.5 x 4.33	41.1	2.8	35 persons	16 persons	14 persons	16 persons	12 persons	16 persons	-
Goodbody Suite I & II	9.5 x 8.66	82.2	2.8	80 persons	40 persons	25 persons	35 persons	24 persons	32 persons	-
Goodbody Suite III & IV	9.5 x 8.66	82.2	2.8	80 persons	40 persons	25 persons	35 persons	24 persons	32 persons	-
B Daly Suite	9.5 x 9.7	92.1	2.8	80 persons	40 persons	25 persons	35 persons	30 persons	40 persons	-
B Daly Suite I	9.5 x 4.85	46	2.8	35 persons	16 persons	14 persons	16 persons	12 persons	16 persons	-
B Daly Suite II	9.5 x 4.85	46	2.8	35 persons	16 persons	14 persons	16 persons	12 persons	16 persons	-
Sterling Boardroom	9.55 x 9.55	91.2	2.6	-	-	-	21 persons	-	Yes	-

Our state-of-the-art conference centre features 9 dedicated meeting rooms, each one with natural light, including an executive boardroom on the first floor with business and communications centre on the ground floor.



Conference Centre Floorplan

Features

- LCD projector and screen
- 42" plasma screens
- Telephone sockets
- Lectern and microphone – Goodbody Suite
- VGA/ video input for connection to LCD projector
- Wireless broadband internet access available
- Business centre facilities

Ceiling Height

2.8m

Daylight

Natural daylight

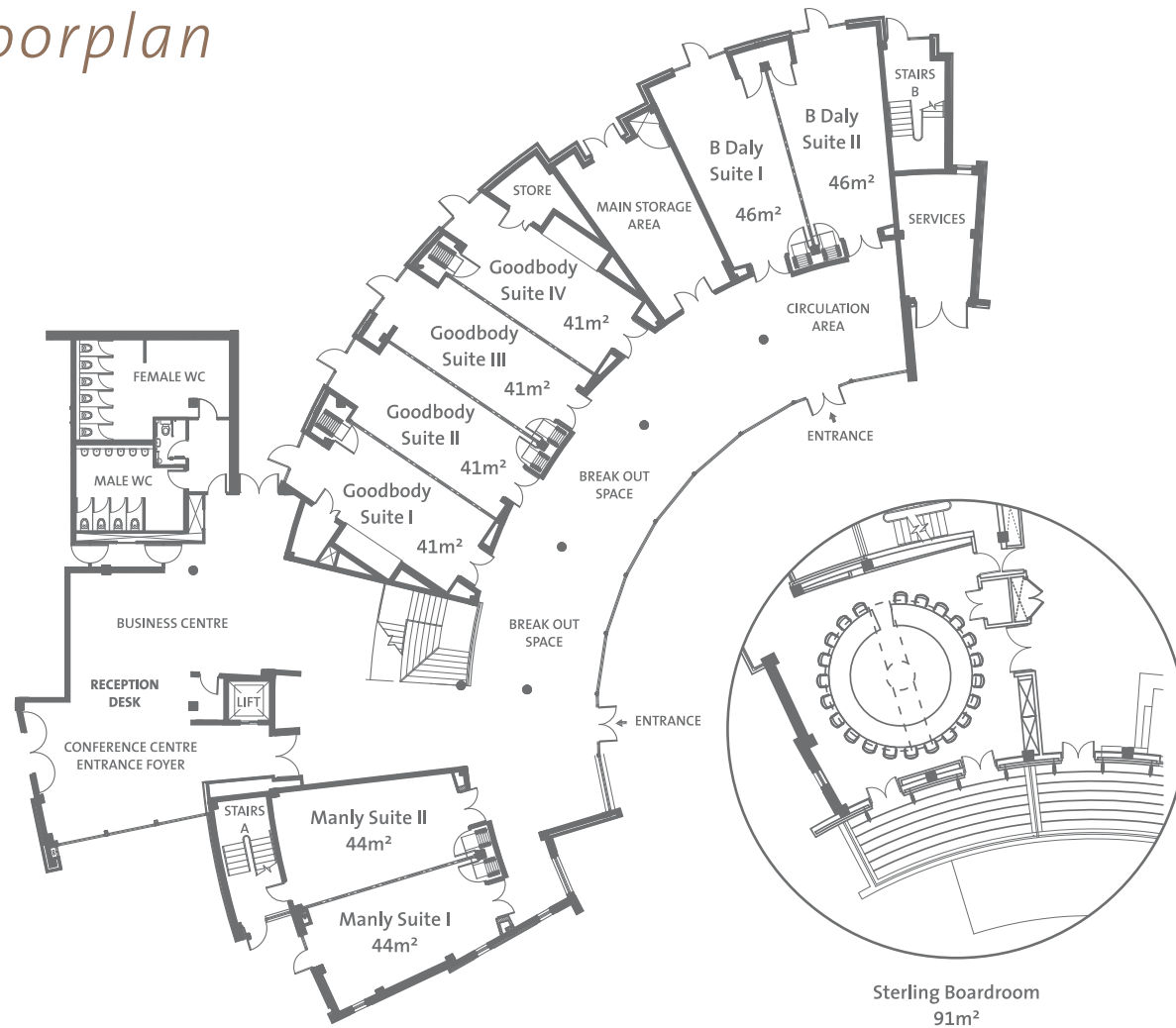

Our principal conference suite, the DE Williams has played host to a wide range of large scale events including product launches, exhibitions and annual association conferences on a national and international scale.



DE Williams Suite Floorplan

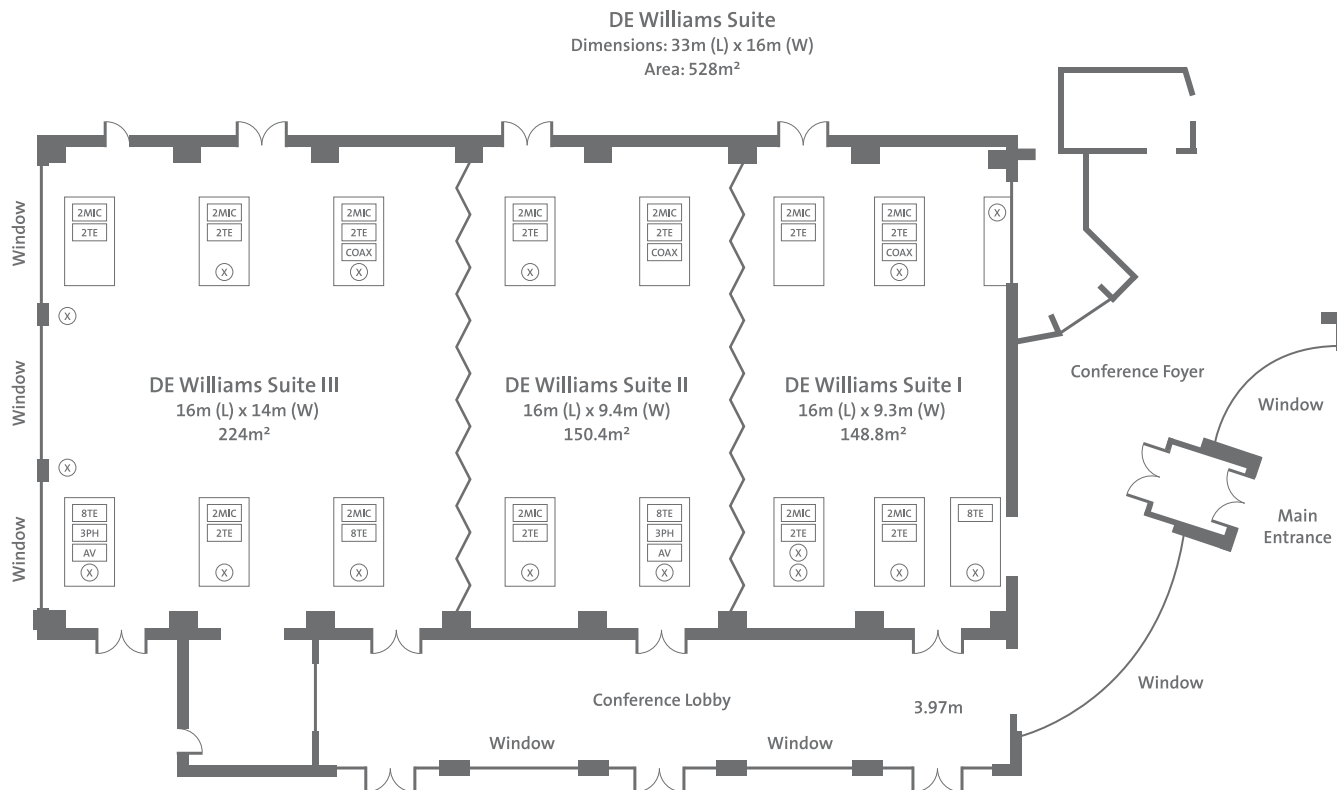

Features

- Sanyo LCD projector ceiling mounted: DEW I / DEW II and DEW III
- Hoist 8" x 8" motorised screen: DEW I and DEW II
- Hoist 10" x 10" motorised screen: DEW III
- Wired microphone points in all rooms
- VGA/ video input for connection to LCD projector
- Lectern point
- Telephone sockets
- Wireless broadband internet access available
- AV room with VHS video player and CD player

Ceiling Heights

Highest point: 4.39 m
Lowest point: 4.11 m

Daylight

Natural daylight: DEW III
Natural daylight: N/A DEW I and DEW II

Symbol Key

3 Phase Electrical Socket	Double Phone Socket
Audio Visual	Eight Phone Sockets
Telephone Socket	Double Microphone Sockets
Coaxial Socket	13 Amp Double Electrical Sockets

The P&H Egan Suite is an adaptable Suite catering for meetings from 5 to 80, and also ideal for private dining groups up to 60 guests.



P&H Egan Suite Floorplan

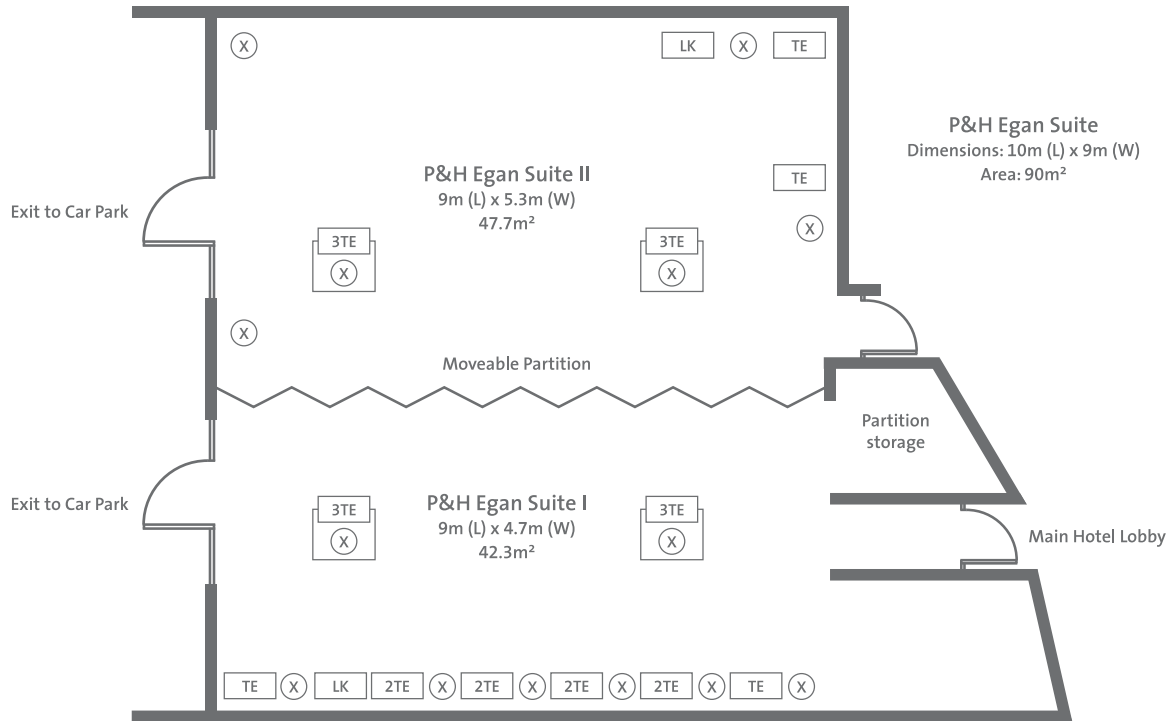

Features

- Pull down ceiling mounted 6" x 6" Screen – P&H Egan I & II
- LCD projector – on request
- 10 phone sockets – P&H Egan
- 2 phone sockets – P&H Egan II
- 2 floor socket boxes with phone and electrical points – P&H Egan I & II
- Wireless broadband internet access available

Ceiling Heights

Highest point: 3.17m
Lowest point: 2.90m

Daylight

Natural daylight

Symbol Key

TE	Telephone Socket	2TE	Double Phone Socket
LK	Link Up	X	13 Amp Double Electrical Sockets